

HJ-1

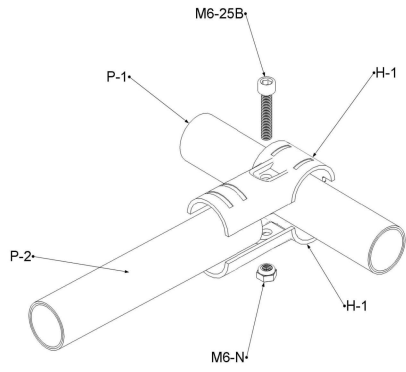

HJ-2

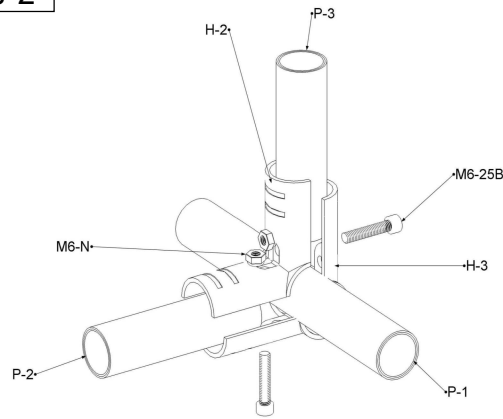

HJ-3

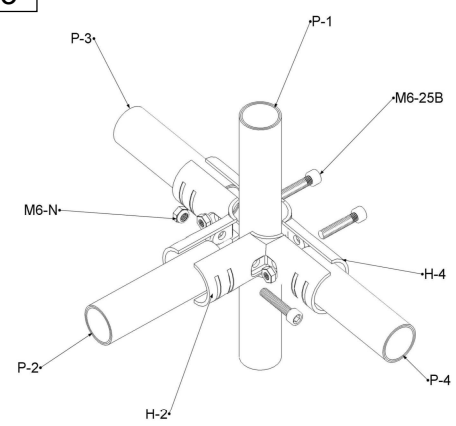

HJ-4

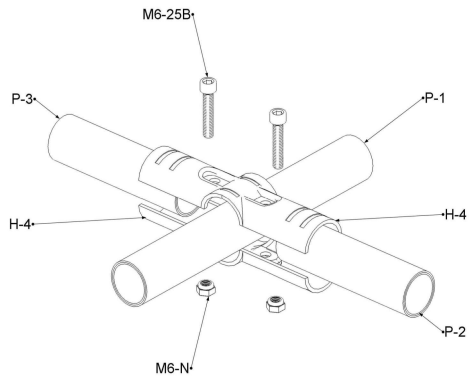

HJ-5

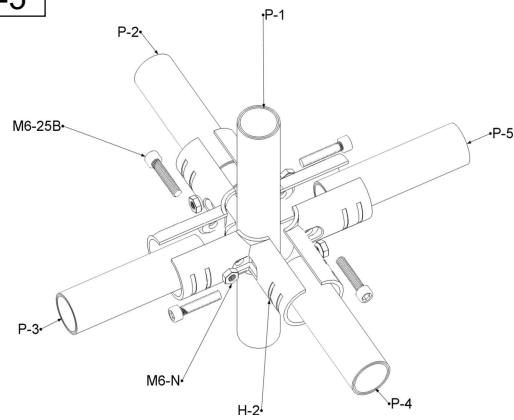

HJ-6

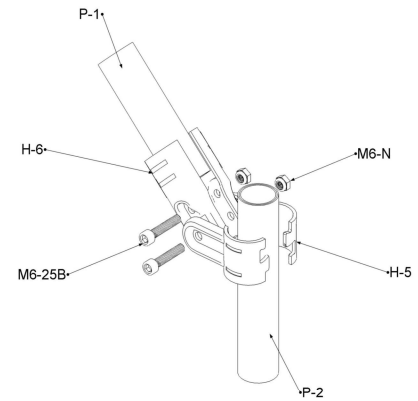

HJ-6A

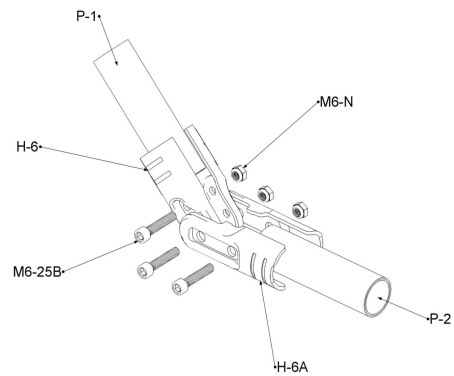

HJ-7

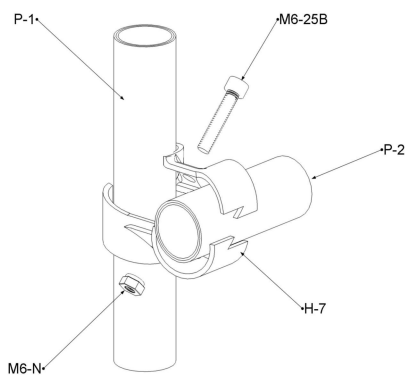

HJ-7A

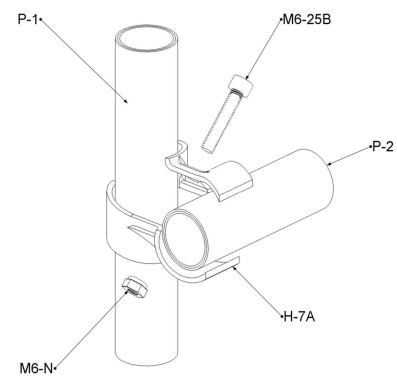

CLIENT  
**FLEXPIPE INC.**

**FLEXPIPE**  
NOM PROJECT / PROJECT NAME  
**FLEXPIPE**  
CONNECTOR

CONCILIARY / DESIGNED BY:  
**M. BEAUDOIN**  
DESIGNER / DRAWN BY:  
**M. BEAUDOIN**  
C/P / PROJECT MANAGER:  
**M. BEAUDOIN**  
MISA JOURNAL / UPDATED ON  
**13-01-2023**

#

CONNECTORS  
HJ-

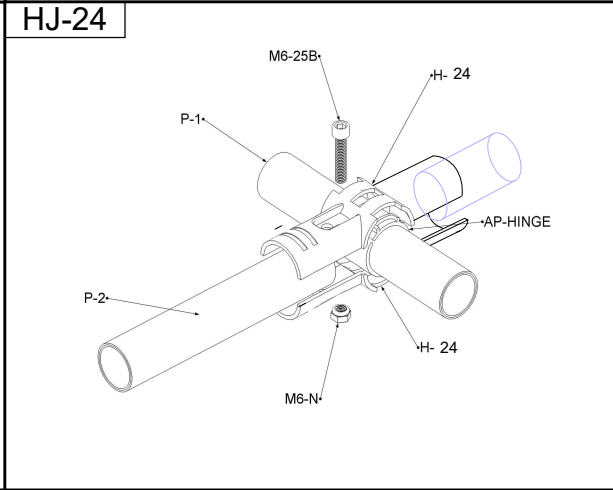
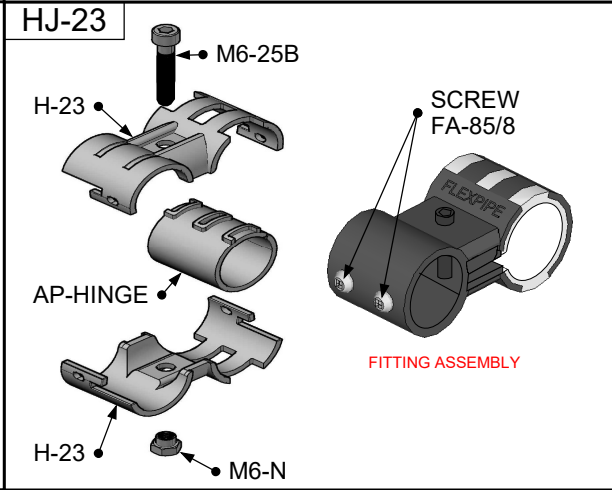
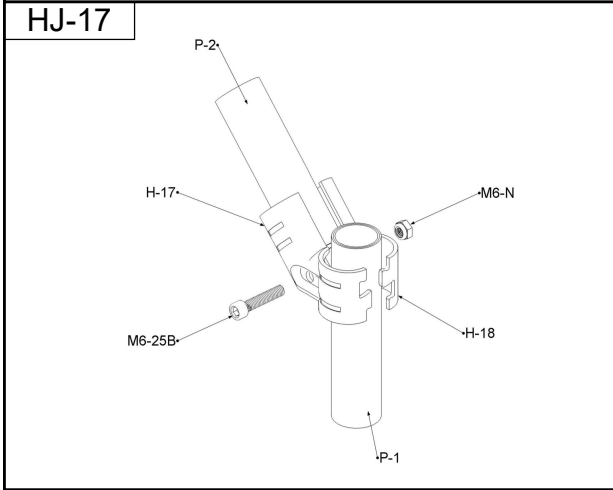
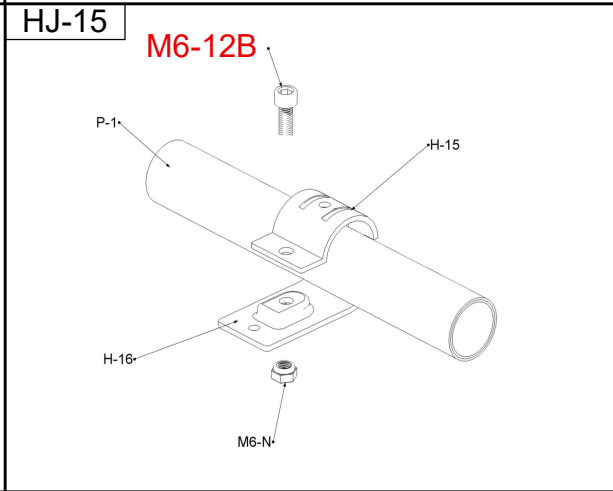
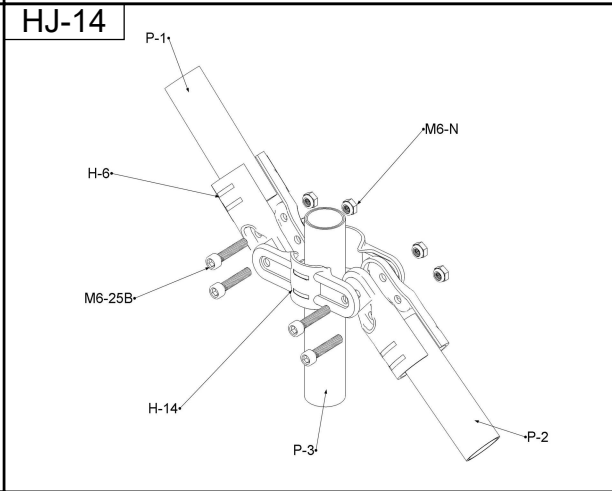
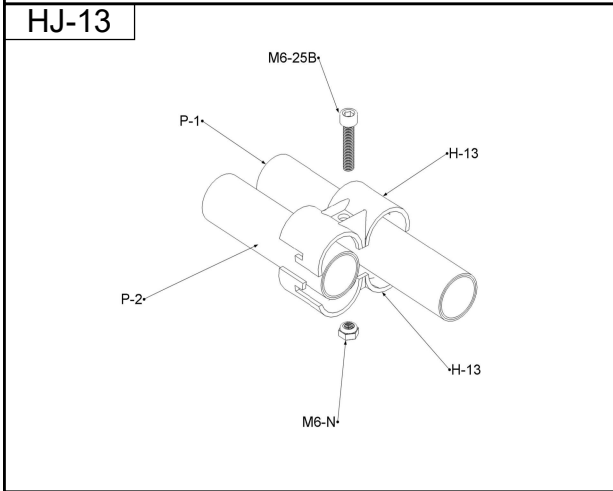
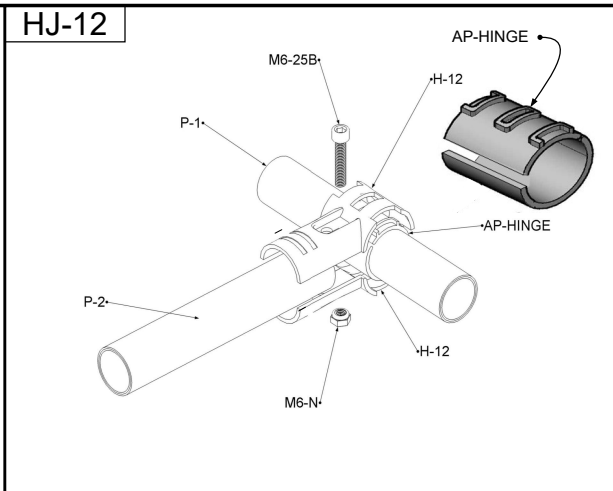
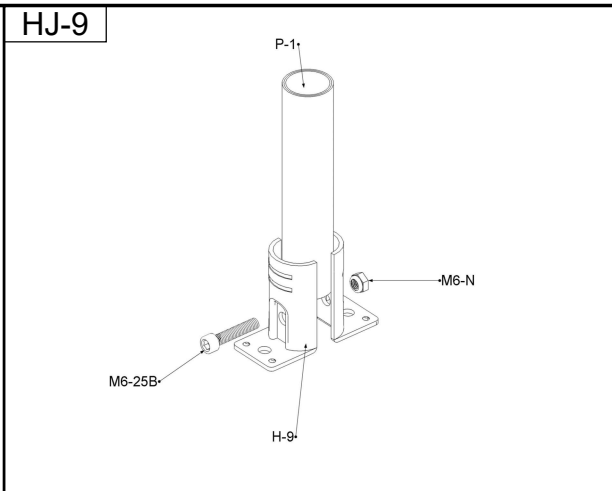
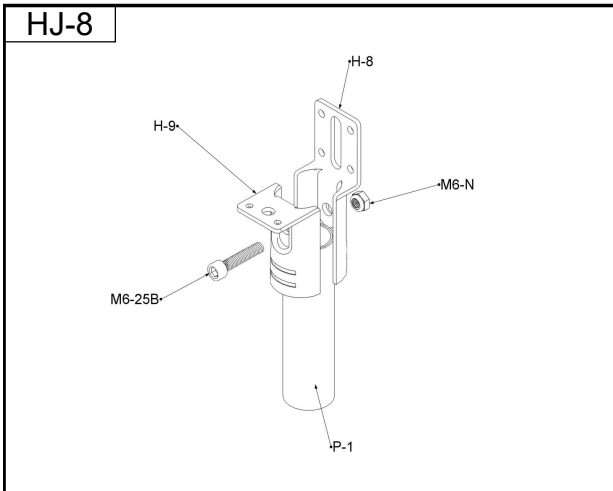

CLIENT  
**FLEXPIPE INC.**

**FLEXPIPE**  
NOM PROJECT / PROJECT NAME  
FLEXPIPE  
CONNECTOR

CONCILIARY / DESIGNED BY: M. BEAUDOIN  
DESIGNER / DRAWN BY: M. BEAUDOIN  
C/P / PROJECT MANAGER: M. BEAUDOIN  
MISA JOURNAL / UPDATED ON: 13-01-2023

#

CONNECTORS  
HJ-

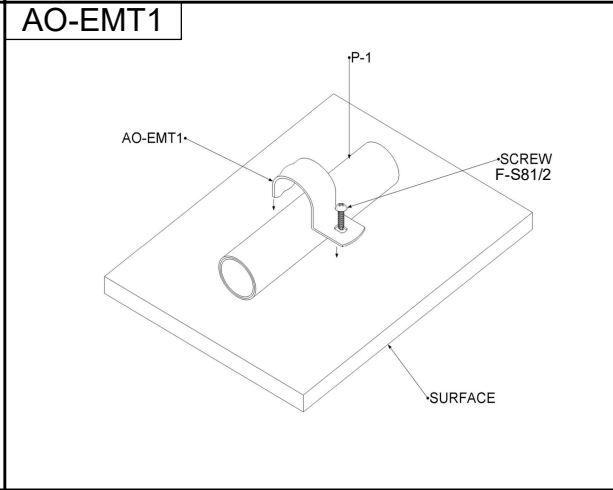
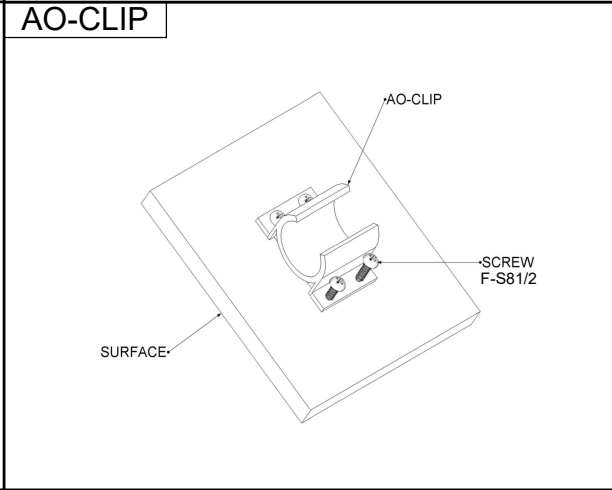
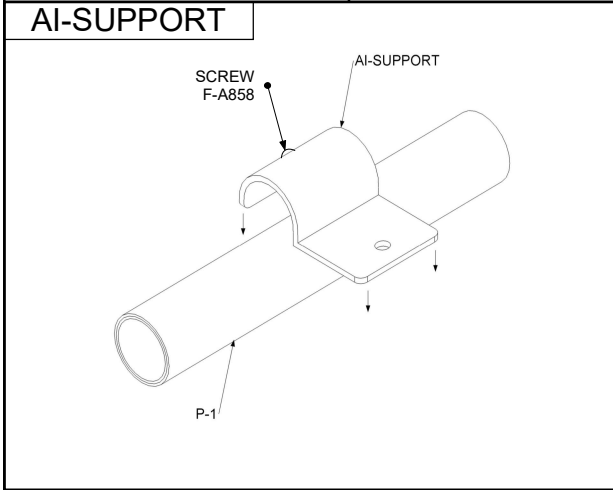
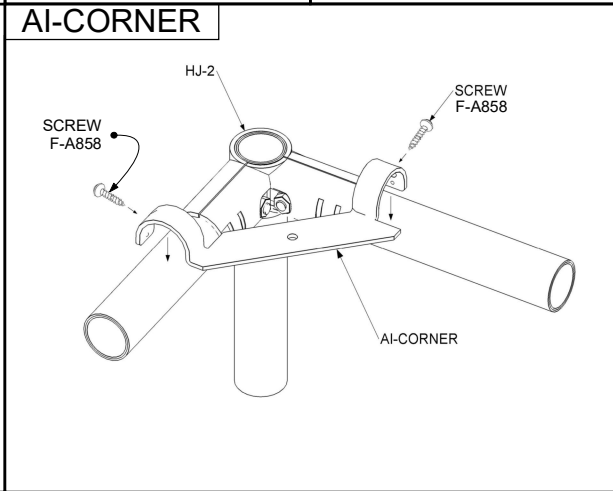
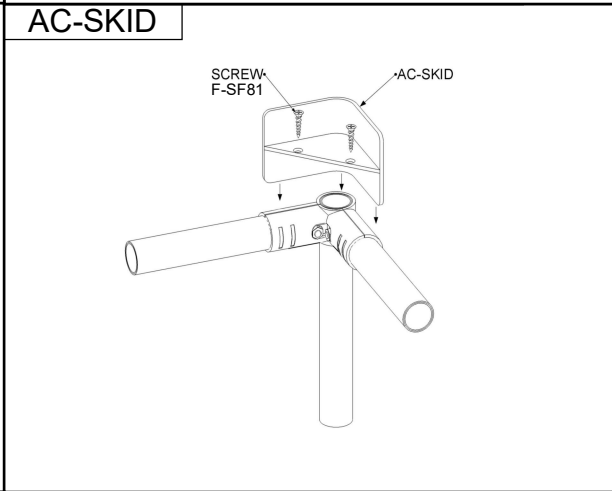
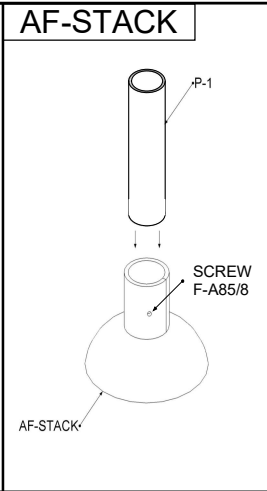
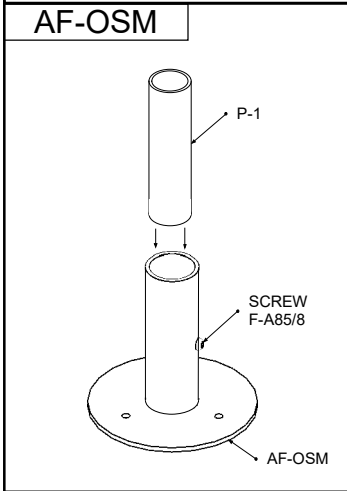
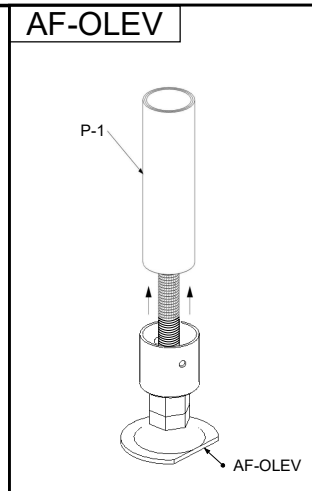
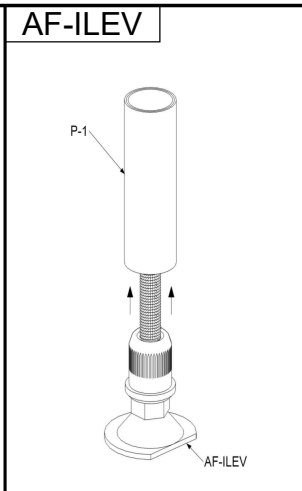
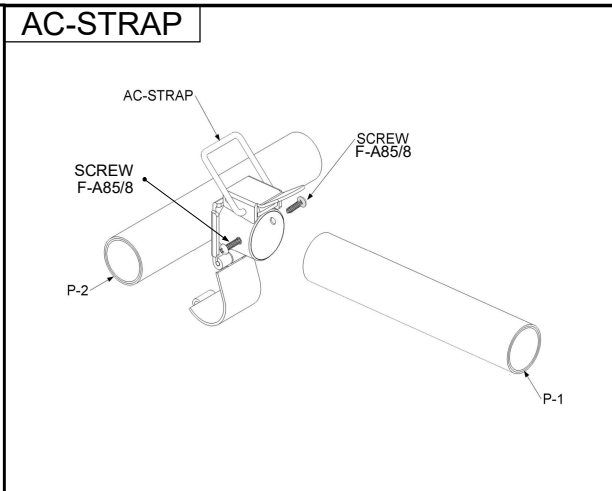
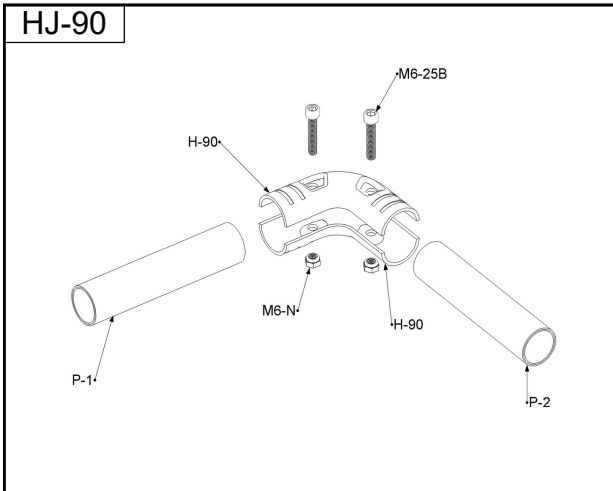

**CLIENT**

**FLEXPIPE INC.**

---

**FLEXPIPE**  
NOM PROJECT / PROJECT NAME  
**FLEXPIPE**  
CONNECTOR

---

CONCEPT / DESIGNED BY:  
**M. BEAUDOIN**

DESIGNER / DRAWN BY:  
**M. BEAUDOIN**

CP / PROJECT MANAGER:  
**M. BEAUDOIN**

MISA JOURNAL / UPDATED ON:  
**13-01-2023**

---

#

**CONNECTORS / ACCESSORIES**

AP-CNNCT

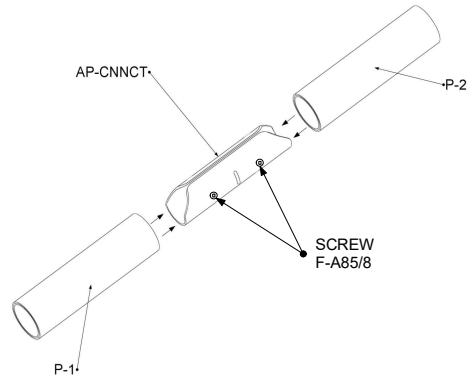

AP-ICAP

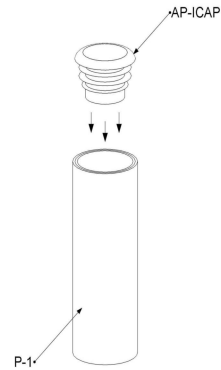

AF-RUB

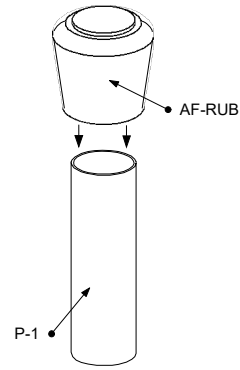

AS-DIVIDER

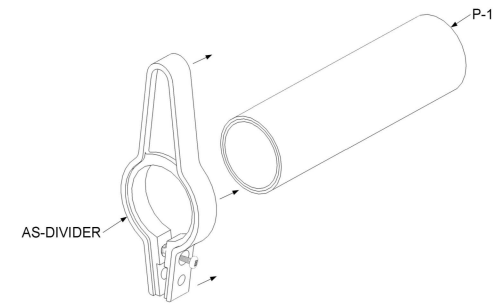

AS-REST

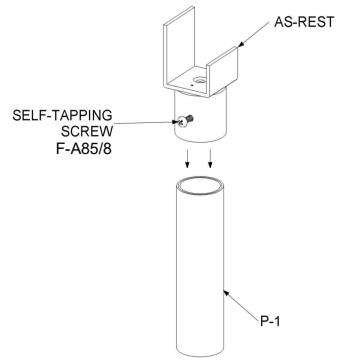

AS-SWIVEL

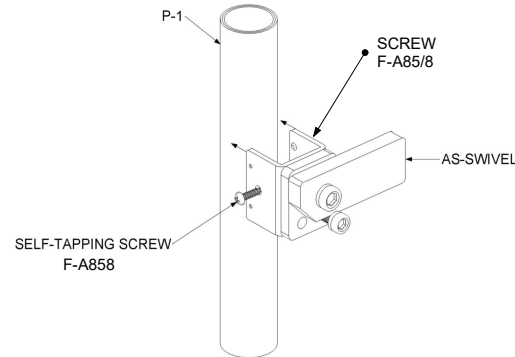

AW-HANGER

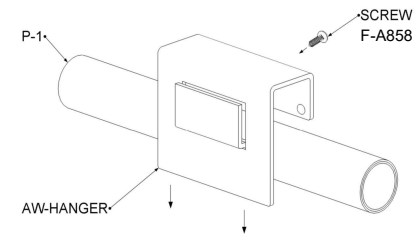

AW-HOLDER

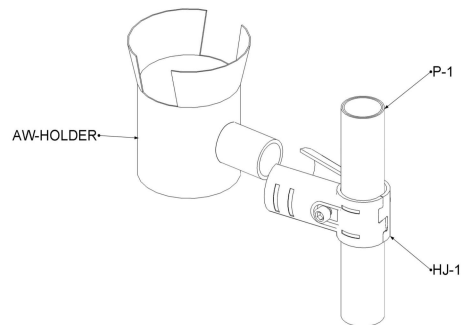

AW-HOOK

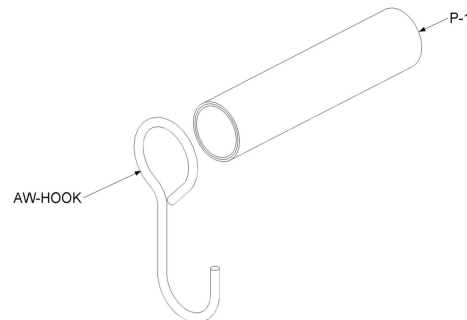

AW-ROLLER

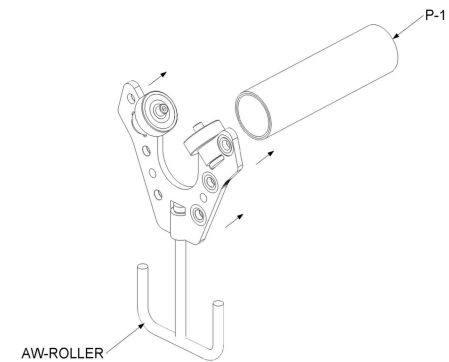

CLIENT  
**FLEXPIPE INC.**

**FLEXPIPE**  
NOM PROJECT / PROJECT NAME  
**FLEXPIPE**  
CONNECTOR

CONCILIARY / DESIGNED BY:  
**M. BEAUDOIN**  
DESIGNER PART / DRAWN BY:  
**M. BEAUDOIN**  
C/P / PROJECT MANAGER:  
**M. BEAUDOIN**  
MISA JOURNAL / UPDATED ON  
**13-01-2023**

#

CONNECTORS/  
ACCESSORIES

## W-3ESB & W-4ESB

- STEP 1: Activate the brake
- STEP 2: Insert the rod inside the pipe
- STEP 3: turn clockside

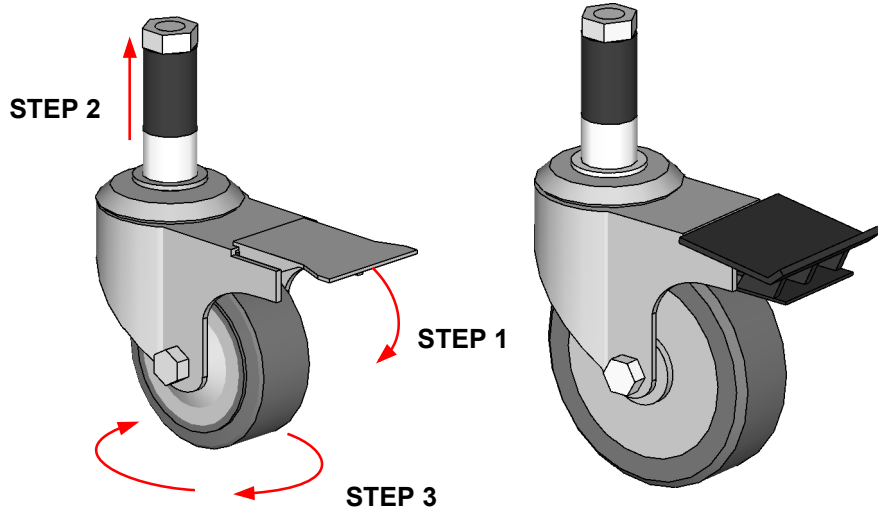

## W-3EF & W-4EF | W-4EF

- STEP 1: Insert & tighten the rod in the tube (using a wrench)
- STEP 2: Place the U-BOLT plate between the fitting & the wheel plate
- STEP 3: Insert & tighten the U-BOLT

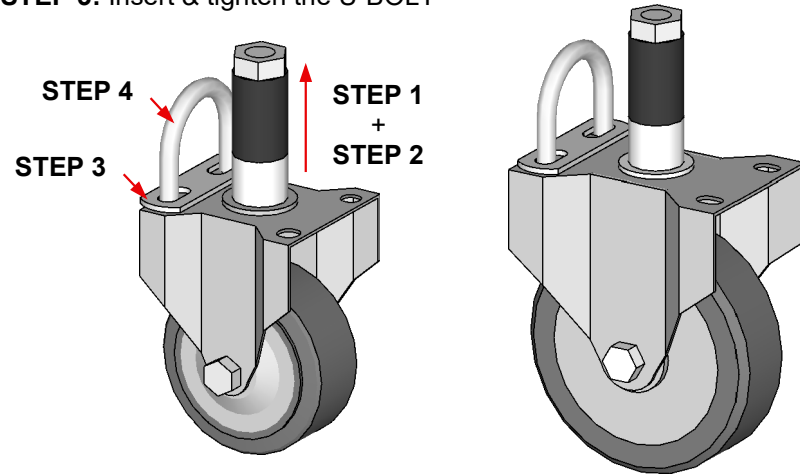

## (W-3ESB + F-BUS) & (W-4ESB + FBUS)

- STEP 1: Activate the brake of the caster
- STEP 2: Remove the original accessories on the wheel stem (EX; NUT + BLACK RUBBER + WHITE BUSHING + WASHER)
- STEP 3: Insert / screw the rod into the F-BUS

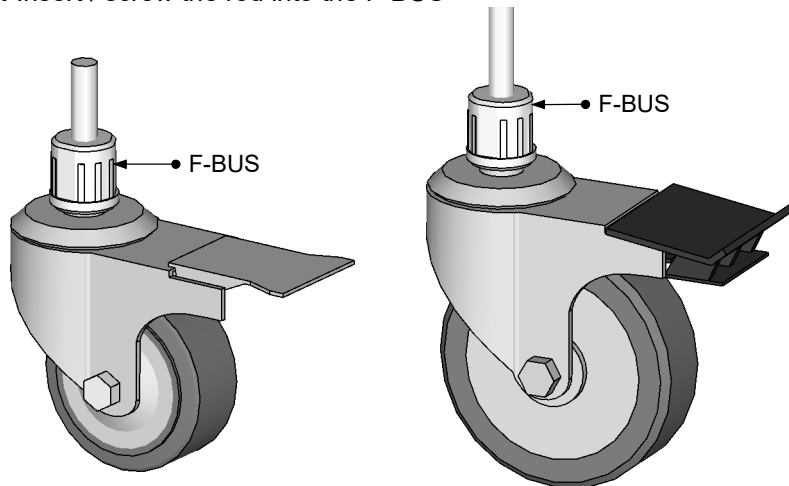

## (W-3EF + F-BUS) & (W-4EF + FBUS)

- STEP 1: Insert the F-BUS in the end of the tube
- STEP 2: Remove the original accessories from the wheel stem
- STEP 3: Insert / screw the rod into the F-BUS
- STEP 4: Place the U-BOLT plate between the fitting & the wheel plate
- STEP 5: Insert & tighten the U-BOLT

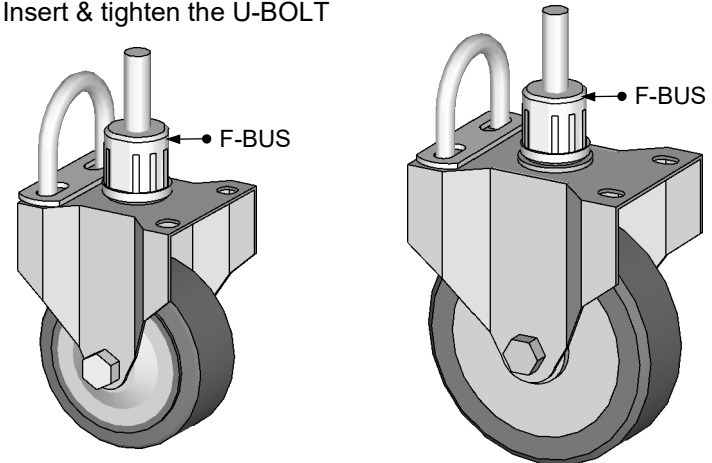

CLIENT  
**FLEXPIPE INC.**

**FLEXPIPE**  
NOM PROJECT / PROJECT NAME  
FLEXPIPE  
CONNECTOR

CONCEPT / DESIGNED BY:  
**M. BEAUDOIN**  
DESIGNER / DRAWN BY:  
**M. BEAUDOIN**  
C/P / PROJECT NUMBER:  
**M. BEAUDOIN**  
MISA 000R LE / UPDATED ON  
**13-01-2023**

#

stem  
casters

W-4PSB

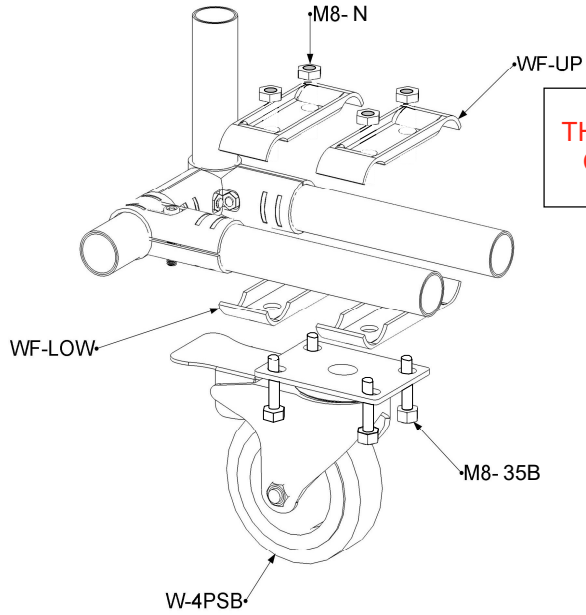

W-4PF

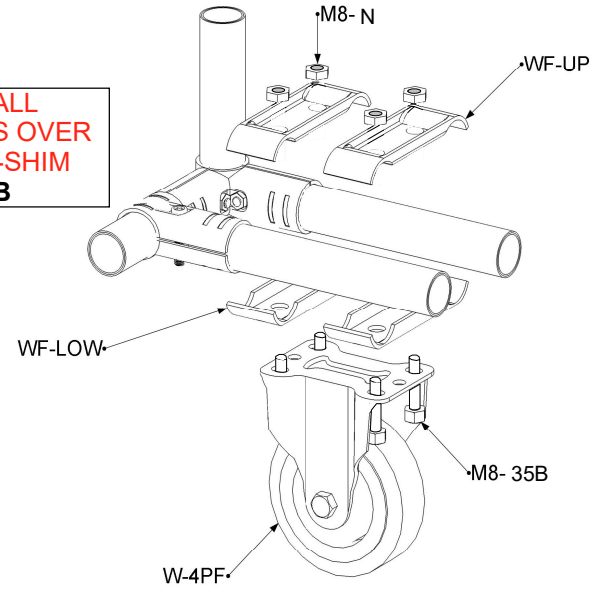

**\*\* IF YOU NEED TO INSTALL  
THE WF-LOW / UP BRACKETS OVER  
CONNECTORS AND/OR AO-SHIM  
USE BOLT SIZE M8-45B**

W-6PSB

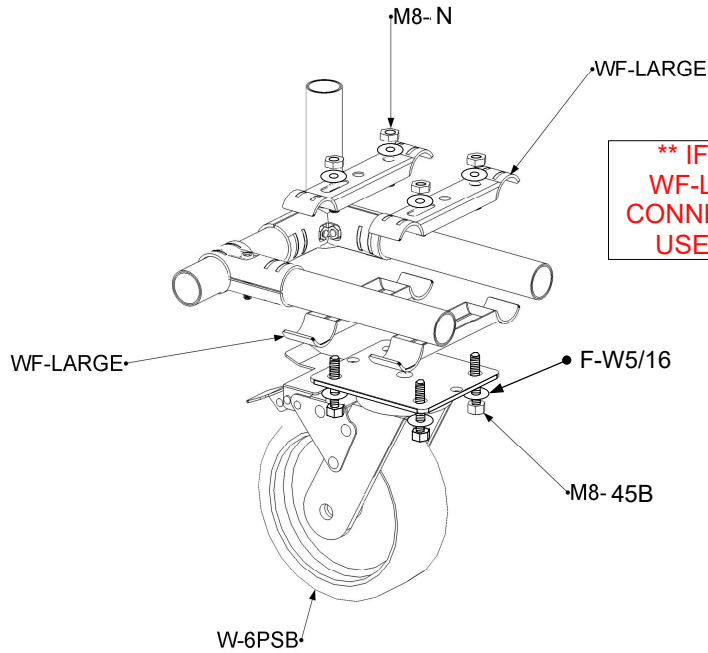

W-6PF

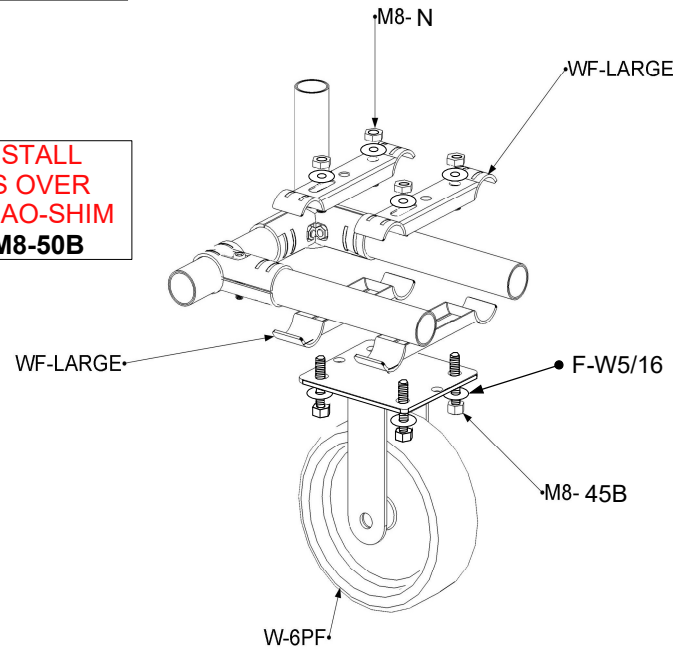

**\*\* IF YOU NEED TO INSTALL  
WF-LARGE BRACKETS OVER  
CONNECTORS AND/OR AO-SHIM  
USE BOLT SIZE M8-50B**

CLIENT  
**FLEXPIPE INC.**

**FLEXPIPE**  
NOM PROJECT / PROJECT NAME  
**FLEXPIPE**  
CONNECTOR

CONCILIARY / DESIGNED BY:  
**M. BEAUDOIN**  
DESIGNER PART / DRAWN BY:  
**M. BEAUDOIN**  
C/P / PROJECT MANAGER:  
**M. BEAUDOIN**  
MISA 001R LE / UPDATED ON  
**13-01-2023**

#

plate  
casters